

DEWALT

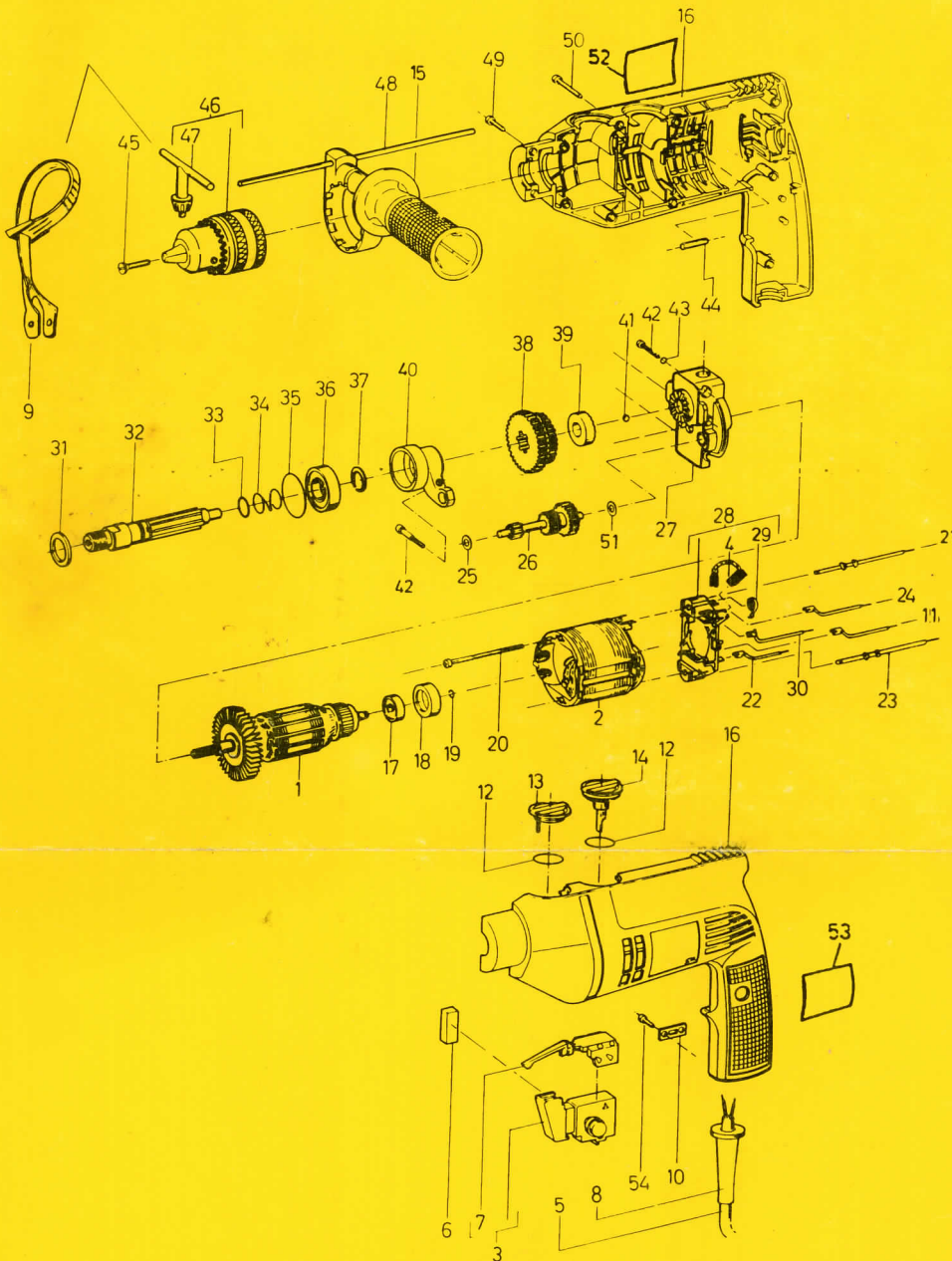

Item No.	Part No.	Description	Q.ty
1	949838-06	Armature	1
2	949855-05	Field	1
3	946203-00	Switch (Incl. 7)	1
4	930802-00	Brush	2
5	330072-26	Power Supply Cord (18-2 SJ)	1
6	930026-00	Block	1
7	938497-01	Switch, Reversing	1
8	949835-01	Cord Protector	1
9	65288-02	Key Holder	1
10	935616-00	Cord Clamp	1
11	940988-45	Terminal	1
12	930039-00	O - Ring	2
13	939637-00	Speed Lever	1
14	946211-00	Selector	1
15	939794-00	Handle Assembly	1
16	283687-03	Field Case (Incl. 52, 53)	1
17	930014-00	Ball Bearing	1
18	930275-00	Bearing Cover	1
19	939624-00	Ring	1
20	939635-00	Screw	2
21	940988-59	Terminal	1
22	940988-43	Terminal	1
23	940988-44	Terminal	1
24	940988-58	Terminal	1
25	930102-00	Washer	1
26	940489-00	Gear & Pinion	1
27	939639-03	Block	1
28	945401-03	Brush Holder (Incl. 4, 29)	1
29	930090-00	Spring	2
30	940988-46	Terminal	1
31	939611-00	Ring	1
32	939621-01	Spindle	1
33	930028-00	Ring	1
34	931890-00	Spring	1
35	938133-00	O-Ring	1
36	330003-12	Ball Bearing	1
37	944137-00	Ring	1
38	940475-00	Gear	1
39	945706-00	Clutch	1
40	943701-01	Front Block Assembly	1
41	930012-00	Ball	1
42	938140-00	Screw	4
43	932839-00	Washer	3
44	941374-00	Rubber Plug	1
45	945013-00	Screw	1
46	790643-00	Chuck & Key	1
47	790644-00	Chuck Key	1
48	940357-00	Depth Gauge	1
49	930284-01	Screw	4
50	930079-01	Screw	9
51	931407-00	Washer	1
52	946193-00	Nameplate	1
53	946194-00	Label	1

LUBRICATION:

Distribute 45 grams of Polyrex grease in gear case. Coat gear teeth.

NOTES:

16 Date code located above nameplate.

EXTRA EQUIPMENT:

(Not Supplied With Unit)

946562-00	Connection Diagram
761995-00	Polyrex Grease (6 oz.)
283484-00	Polyrex Grease (32 oz.)

IMPORTANT! To assure product SAFETY and RELIABILITY, repairs, maintenance and adjustment should be performed by Service Centers of the INDUSTRIAL TOOL DIVISION of BLACK & DECKER or other qualified service organizations, always using DEWALT replacement parts.

When servicing Double Insulated Tools, it is extremely important that ONLY IDENTICAL REPLACEMENT PARTS BE USED and that REASSEMBLY OF TOOL IS IDENTICAL TO THE ORIGINAL ASSEMBLY.

DEWALT

1/2" V.S.R. HAMMER DRILL

Cat. no.	Type	Volts	Amps	RPM
DW 512	100	120	5.0	0÷1050/0÷2700
AC Only				

Service Cat. No. 0512